

# Model '687' Mouse Ventilator User's Manual



'687' Mouse Ventilator MA1 55-0001



# Table of Contents

---

<b>SUBJECT</b>	<b>PAGE #</b>
<b>General Information - Warranty &amp; Repairs</b>	<b>2</b>
<b>General Safety Summary</b>	<b>3</b>
<b>Specifications</b>	<b>4</b>
<b>Description &amp; Features</b>	<b>5</b>
<b>Voltage Selection</b>	<b>6</b>
<b>Fuse Replacement</b>	<b>6</b>
<b>Pump Operation:</b>	
Connecting to Animal	7
Selecting Rate & Volume	9
Setting Volume & Rate	9
Using Gas Mixtures	9
Creating a PEEP	9
<b>Cleaning &amp; Maintenance</b>	<b>10</b>
<b>Changing Piston &amp; Cylinder</b>	<b>11-12</b>

# General Information

---

## Serial Numbers

All inquiries concerning our product should refer to the serial number of the unit. Serial numbers are located on the rear of the chassis.

## Calibrations

All electrical apparatus is calibrated at rated voltage and frequency. While the flow will stay calibrated, the peak will vary.

## Warranty

Harvard Apparatus warrants this instrument for a period of one year from date of purchase. At its option, Harvard Apparatus will repair or replace the unit if it is found to be defective as to workmanship or material.

This warranty does not extend to damage resulting from misuse, neglect or abuse, normal wear and tear, or accident.

This warranty extends only to the original customer purchaser.

IN NO EVENT SHALL HARVARD APPARATUS BE LIABLE FOR INCIDENTAL OR CONSEQUENTIAL DAMAGES. Some states do not allow exclusion or limitation of incidental or consequential damages so the above limitation or exclusion may not apply to you. THERE ARE NO IMPLIED WARRANTIES OF MERCHANTABILITY, OR FITNESS FOR A PARTICULAR USE, OR OF ANY OTHER NATURE. Some states do not allow this limitation on an implied warranty, so the above limitation may not apply to you.

If a defect arises within the two-year warranty period, promptly contact Harvard Apparatus, 84 October Hill Road, Building 7, Holliston, Massachusetts 01746-1371 using our toll free number 1-800-272-2775. Goods will not be accepted for return unless an RMA (returned materials authorization) number has been issued by our customer service department. The customer is responsible for shipping charges. Please allow a reasonable period of time for completion of repairs, replacement and return. If the unit is replaced, the replacement unit is covered only for the remainder of the original warranty period dating from the purchase of the original device.

This warranty gives you specific rights, and you may also have other rights which vary from state to state.

## Repair Facilities and Parts

Harvard Apparatus stocks replacement and repair parts. When ordering, please describe parts as completely as possible, preferably using our part numbers. If practical, enclose a sample or drawing. We offer a complete reconditioning service.



### CAUTION

**This ventilator is not registered with the FDA and is not for clinical use on human or veterinary patients. It is intended for research use only.**

# General Safety Summary

---

Please read the following safety precautions to ensure proper use of your ventilator. To avoid potential hazards and product damage, use this product only as instructed in this manual. If the equipment is used in a manner not specified by the manufacturer, the protection provided by the equipment may be impaired.

## To Prevent Hazard or Injury:

### Use Proper Line Cord

Use only the specified line cord for this product and make sure line cord is certified for country of use.

### Ground the Product

This product is grounded through the grounding conductor of the power cord. To avoid electric shock, the grounding conductor must be connected to earth ground. Before making any connections to the input or output terminals of the product, ensure that the product is properly grounded.

### Make Proper Connections

Make sure all connections are made properly and securely.

### Orient Equipment Properly

Do not position the equipment such that it is difficult to reach the disconnecting device.

### Avoid Pinch Hazard

A pinch hazard may exist between the piston shaft coupling and the cylinder. Avoid placing fingers between these points while the ventilator is running.

### Observe all Terminal Ratings

Review the operating manual to learn the ratings on all connections.

### Use Proper Fuse

Use only specified fuses with product.

### Avoid Exposed Circuitry

Do not touch any electronic circuitry inside of the product.

### Do Not Operate with Suspected Failures

If damage is suspected on or to the product do not operate the product. Contact qualified service personnel to perform inspection.

### Place Product in Proper Environment

Review the operating manual for guidelines for proper operating environments.

### Observe all Warning Labels on Product

Read all labels on product to ensure proper usage.



# Specifications

<b>'687' MOUSE VENTILATOR SPECIFICATIONS</b>	
Rate	Adjustable from 30 to 150 strokes/min while the ventilator is running
Phase Ratio	1:1 fixed
Dimensions,	25 x 32.5 x 20 cm
H x L x W	(10 x 13 x 8 in)
Weight	9.5 kg (21lbs)
Power	100-120 VAC/200-230 VAC, 0.8A/0.40A max., 50/60 Hz
Stroke Rate	Continuously variable from 30 to 150 strokes/min while the ventilator is running, with LIGHT-EMITTING DIODE (LED) DISPLAY.
Volume	Adjustable from 0.05 to 1 ml/stroke while the ventilator is running
Environmental:	
Operating Temperature	0°C to 40°C (32°F to 104°F)
Operating Humidity	20% to 80% RH, non-condensing
Installation Category	II
Pollution Degree	1
Port:	
Part Number	5121-074
Size	
ID	1.98 mm (0.078 in)
OD	3.17 mm (0.125 in)
Catalog No.	55-0001
Accessories	
55-5281	Overhaul Kit for Mouse Ventilator; contains O-rings, valve springs, lubricants, etc. to overhaul Ventilator
73-3076	Connection Kit for Anesthesia/Pressurized Gas Connection
Fuse	250V 0.7A

# Description & Features

---

The MODEL 687 is a positive volume ventilator intended to meet the respiratory requirements of small rodents weighing up to 150 g (0.55 lb).

- A new orientation allows for minimal system dead space and thus more precise tidal volume delivery to the animal

This ventilator is furnished with a 1 cc piston/cylinder assembly of 0.05 to 1.0 ml/breath. The mechanical design features a linkage that enables the piston to touch the end of the cylinder at each stroke regardless of the volume. This assures that all the air/gas mixture taken into the ventilator is expelled at each stroke.

A positive mechanical slide valve is actuated by a cam on the motor to synchronize inspiration and expiration with the motion of the piston. Any **NON-EXPLOSIVE** gas/air mixture can be used with the ventilator. A three-way slide valve is attached to the mechanism plate at the end of the cylinder and actuated by a cam on the motor. Connection kit (73-3076) is suggested for this connection.

**THIS VENTILATOR IS NOT TO BE USED IN AN EXPLOSIVE ATMOSPHERE OR WITH ANY EXPLOSIVE GASES SUCH AS ETHER OR CYCLOPROPANE, ETC. THESE VENTILATORS ARE NOT EXPLOSION-PROOF.**

# Voltage Selection/Fuse Replacement

## Voltage Selection

1. The '687' Ventilator is equipped with a 115/230V selector feature, which is incorporated into the power entry module located on the side of the unit (see figure below). The Ventilator is shipped from the factory with the voltage selector set at 115V. To change voltage from 115V to 230V, follow these steps:
  - a. Turn off main power, and disconnect power cord.
  - b. Using a small flathead screwdriver, pry open the fuse access door on the power entry module (see figure below).
  - c. Remove fuse holder by using the small flathead screwdriver.
  - d. Rotate the red fuse holder 180 deg. and install back into power entry module.
  - e. Close small access door firmly until fully closed. In power entry module window (see detail below) 230V should be seen.
  - f. Re-install power cord.
2. Turn on main power switch located on the rear panel. The display will now illuminate. The number displayed is the current strokes per minute rate.

## Fuse Replacement Key Information

1. Make sure power cord is disconnected from the main power supply before servicing the fuse.
2. Use only Type 3AG, 1/4" x 1-1/4", 0.75 amp, 250 volts; Type T (time delay) fuses (Harvard Apparatus part # 5153-554 or equivalent).

Turn off power and remove power cord from power module. Use a straight blade screwdriver to pry open the access door. Remove the fuse holder and then remove the fuses from this holder as shown in the figure below. Replace fuses using only 0.75 amp, 250 volts, Type T fuses. Then replace the fuse holder.

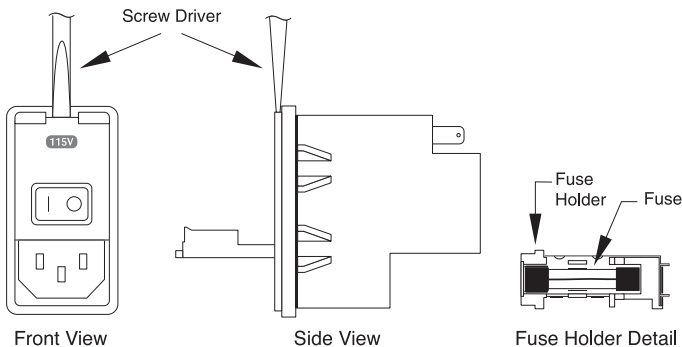

*Note: A non-operator-replaceable fuse exists inside of the equipment. This fuse is rated T 40mA 250V, 5 x 20mm.*

# Operating the Pump

## Connection to the Animal

The vertical slide valve has four ports (see figure below):

- The **top port** (furthest from the chassis in new orientation) is the returchannel from the animal, which leaves the Pump at the port on the side.

It is at this top port that expired air can be collected or recycled.

- The **middle port** is the room air/gas channel to the animal.
- The **bottom port** (closest to the chassis in new orientation) is the room air or gas mixture intake.

*Note: It is important that the tubes to and from the animal be as short as possible. The new orientation allows the animal to be as close as possible to the Ventilator for minimal dead space in the system.*

The actual connection to the animal can be either:

- Tracheal cannula with y adapter
- Intubation cannula with y adapter

A selection of tracheal cannula and endotracheal tubes are listed in the Harvard Apparatus Catalog and on our website [www.harvardapparatus.com](http://www.harvardapparatus.com). It is important that the volume of tubing shared by inspired and expired air (dead space) be kept to a minimum by having the “Y” or “T” connector as close to the animal as possible.

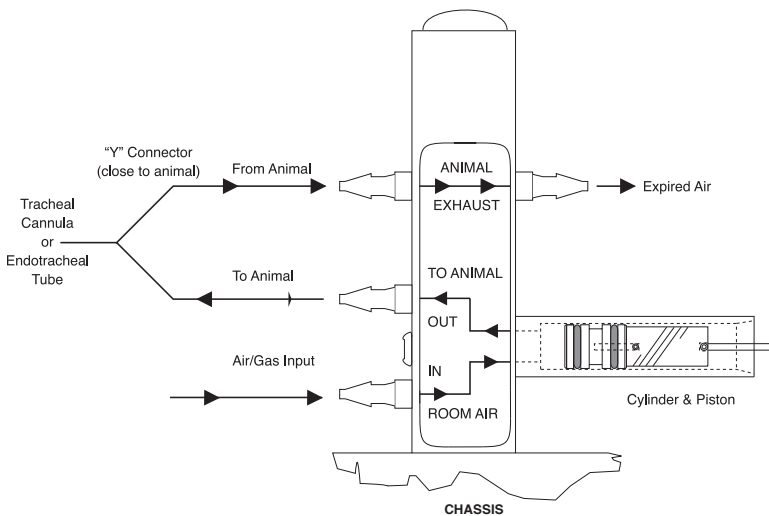



# Operating the Pump

## Ventilator Graph

Tidal Volume vs. Weight & Rate for Laboratory Mammals in Resting State.  
(Apparatus dead space must be added)

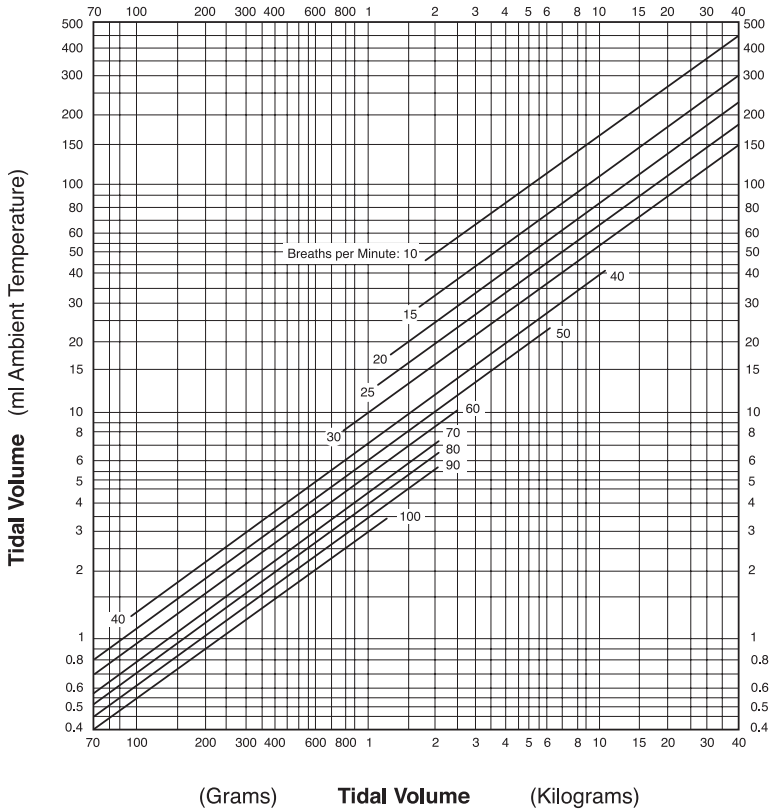

Ventilation Parameters Mammals with < 70g Body Mass		
Body Mass (g)	Vt (ml)	Rate (BPM)
15	0.1	159
20	0.12	148
30	0.18	133
40	0.24	123
50	0.30	117
60	0.36	111
70	0.42	107

# Operating the Pump

---

## Selection of Rate and Volume

Refer to the Ventilator Graph (above) to select the appropriate tidal volume and respiration rate as a function of animal body weight.

## Setting Volume

The volume delivered is read by observing the excursion of the O-ring, on the piston, which is closest to the valve block. This piston O-ring excursion is relative to the volume scale on the outside of the cylinder wall. Volume change is accomplished while the Ventilator is running by turning “volume” knob in the desired direction.

## Setting Rate

Adjust the “Rate” control until the desired rate appears on the LED display. Avoid running the Ventilator at rates exceeding 150 breaths/min for periods in excess of 2 hours.



### CAUTION

**Do not over inflate the animal. A good rule of thumb is to observe the depth of respiration in the normal calm unanesthetized animal and adjust the volume to approximate this respiration depth when the animal is attached to the Ventilator.**

## Use of Gas Mixture

It is possible to introduce non-explosive air/gas mixtures into the lower room air port. However, the source of gas mixture is usually from a tank delivering gas is at a constant rate while the Ventilator takes in air/gas intermittently. Some sort of buffer/expansion chamber must be provided between the tank and the Ventilator. Harvard Apparatus offers a connection kit (73-3076) to depressurize the gas prior to entering the Ventilator. **This Ventilator is not designed to take air/gas inputs under pressure.**

## Creating a Positive End-Expiratory Pressure (PEEP)

To create a PEEP pressure when using the ventilator, simply connect a length of tubing to the “Exhaust” port and submerge the other end in a column of water. There are two locations in which the clip and cylinder can be installed - depending on the chosen orientation. The depth of the end of the tubing (in cm) below the water surface will give the PEEP pressure in cmH<sub>2</sub>O.

# Cleaning & Maintenance

---

## Cleaning

To clean the exterior surfaces, use a lint-free cloth to remove loose dust. Use care to avoid scratching the clear display window. For more efficient cleaning, use a soft cloth dampened with water or an aqueous solution of 75% isopropyl alcohol.

## Maintenance

No special maintenance is required other than periodic lubrication of the piston O-rings and the slide valve with the special non-toxic grease provided. To get to the slide valve for lubrication:

1. Remove the four screws holding the valve to the 1/4" aluminum black back plate.
2. Remove the screws in front that hold the cylinder and valve together.
3. Lift entire valve assembly up and out of Ventilator.
4. Pull stainless steel valve rod free of valve block.
5. Lubricate sparingly.

## Model 687 Rodent Ventilator Replacement Parts

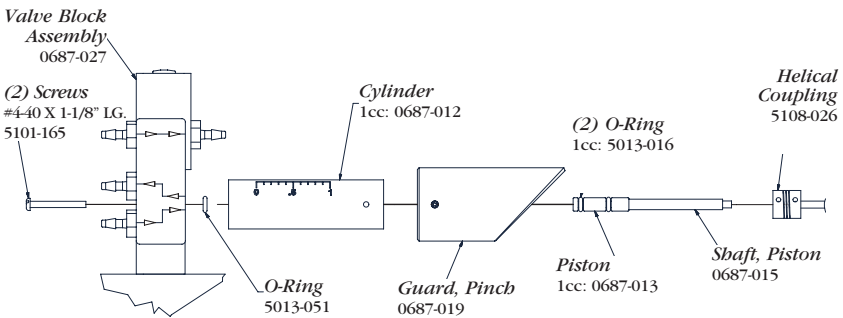

## Lubrication

This Model 687 Ventilator is shipped with the appropriate grease to lubricate the piston and O-rings in the cylinders and for metal to metal applications such as the inside of the slide valve.

# Changing Piston and Cylinder

---

This Ventilator is furnished with a 1 cc piston and cylinder.

*Note: It is **extremely important** when removing piston and cylinders that they be aligned to be concentric and in line with the piston shaft.*

The cylinder is fastened to the 4 port vertical slide valve by means of two screws located between the “room air inlet” port and the “to animal” port on the front of the slide valve.

The vertical slide valve is fastened to the black 1/4” aluminum sub base by four screws located on the opposite side from the printed label. By using these six screws, two in front and four on the side, alignment adjustments are made (see below).

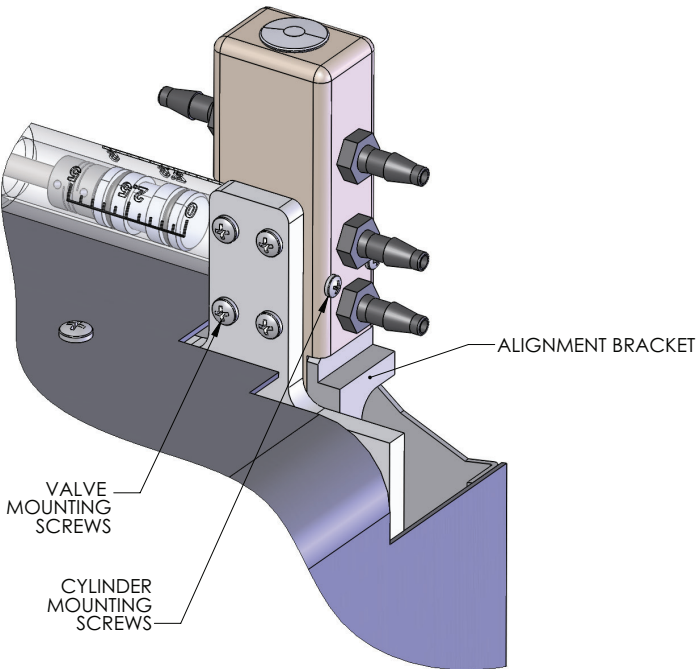

# Changing Piston and Cylinder

---

## To remove the cylinder and piston

1. Remove the two screws securing the pinch guard. Position the guard to gain access to the helical coupling.
2. Set the Ventilator volume to maximum.
3. Run Ventilator at lowest speed and stop the Ventilator when the helical coupling is exposed.



**CAUTION:**

**A pinch hazard exists when the guard is removed. Service should only be performed by trained personnel.**

4. Using a 0.050 Allen wrench (provided), disconnect the white piston from the coupling, leaving the coupling on the piston shaft.
5. Remove the two screws located in the front of the slide valve.
6. Remove piston and cylinder.
7. Be careful to save the O-ring that is recessed in the slide valve block between the screws. The O-ring provides the airtight seal between the plastic cylinder and the valve block.

## To install the piston and cylinder

1. Pick out the new piston and cylinder.
2. Using pliers, remove the piston and lubricate with the grease provided.
3. Insert the lubricated piston in the cylinder so that the rear of the piston is flush with the rear of the cylinder with the 1/8" diameter coupling stud protruding.
4. Install the pinch guard on the cylinder, but do not install screws.
5. Fasten the cylinder to the valve block with the two screws, making sure the O-ring is in place. Do not tighten these two screws completely, but just enough to hold the cylinder in place.
6. The object of alignment is to have the stud at the end of the piston be exactly in line with its mating hole in the helical coupling. This insures that the piston moves freely within the cylinder without undue friction.
7. The two screws at the front of the valve block control left to right alignment while the four screws at the rear of the slide valve control up and down alignment. By adjustment of these 6 screws the proper alignment can be made. Remember that the screws interact with one another so the procedure may have to be repeated one or more times.
8. When proper alignment is achieved, the helical coupling should be connected. If alignment is correct, the coupling should slide onto the piston stud without bending of the piston rod.
9. Install the two screws to secure the pinch guard.

# Repair Kit

---

## Repair Instructions for the 687 Respirator

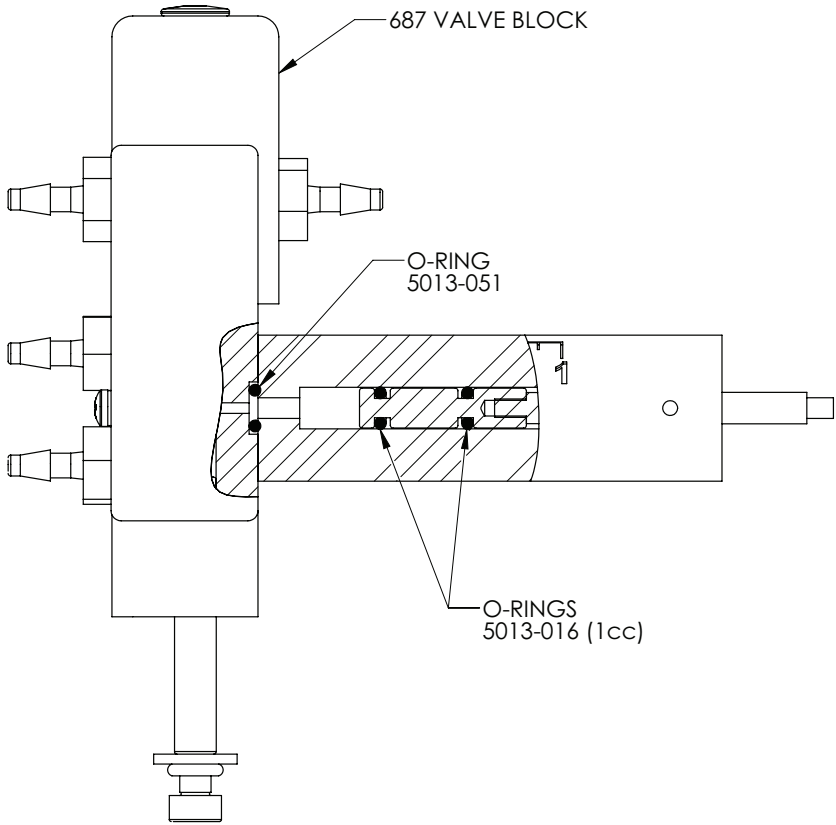

# Notes

---

# Notes

---



# Notes

---

## U.S.A.

### **Harvard Apparatus**

84 October Hill Road

Holliston, Massachusetts 01746

Phone (508) 893-8999

Toll Free (800) 272-2775

Fax (508) 429-5732

E-mail support@hbiosci.com

Web www.harvardapparatus.com

## Canada

### **Harvard Apparatus, Canada**

6010 Vanden Abeele Street

Saint Laurent, Quebec, H4S 1R9

Phone (514) 335-0792

Toll Free (800) 361-1905

Fax (514) 335-3482

E-mail sales@harvardapparatus.ca

Web www.harvardapparatus.ca

## France

### **Harvard Apparatus, S.A.R.L.**

6 Avenue des Andes

Miniparc – Bat. 8

F-91952, Les Ulis Cedex

Phone (33) 1-64-46-00-85

Fax (33) 1-64-46-94-38

E-mail info@harvardapparatus.fr

## Germany

### **Hugo Sachs Elektronik**

Gruenstrasse 1

March-Hugstetten D-79232, Germany

Phone (49) 0 7665.92.00.0

Fax (49) 0 7665.92.00.90

E-mail info@hugo-sachs.de

Web www.hugo-sachs.de

## Sweden

### **CMA Microdialysis AB**

Torshamnsgatan 30A

SE-164 40 KISTA, Sweden

Phone +46.8.470.10.00

E-mail cma@microdialysis.se

Web www.microdialysis.com

## Spain

### **Panlab S.L.U.**

C/ Energia, 112

08940 Cornellà (Barcelona), Spain

Phone +46 8 470 10 00

Fax +46 8 470 10 50

E-mail info@panlab.com

Web www.panlab.com

## United Kingdom

### **Biochrom**

1020 Cambourne Business Park

Cambourne, Cambridge, CB23 6DW UK

Phone (44) 1223.423.723

Fax (44) 1223.420.164

E-mail enquiries@biochrom.co.uk

Web www.biochrom.co.uk

## China

### **Harvard Bioscience (Shanghai) Co., Ltd.**

Room 8C, Zhongxi Tower

121 Jiangsu Road,

Changning District

Shanghai, China 200050

Phone +86 21 6226 0239